

CITY OF ELLIOT LAKE OFFICIAL PLAN

LAND USE SCHEDULE A-1 TO AMENDMENT NO. 2 TO THE OFFICIAL PLAN OF THE CITY OF ELLIOT LAKE

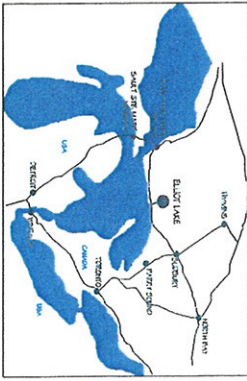

KEY LOCATION MAP
Date: September 25, 2006

- LEGEND**
- Rural Areas
 - Residential
 - Central Commercial
 - Neighbourhood Commercial
 - Tourist/Highway Commercial
 - Light Industrial
 - Industrial
 - Parkland
 - Community Improvement Area
 - Waste Management Facility (Open)
 - Waste Management Facility (Closed)
 - Mount Dufferin Recreational Development Area
 - Provincial Highway
 - Urban Collector Streets
 - Urban Local Streets

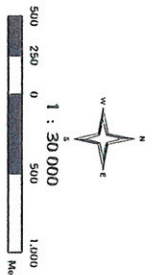

NOTE:
This map is for general illustration purposes only.
For boundary interpretations, please contact the
Department of the City of Elliot Lake.

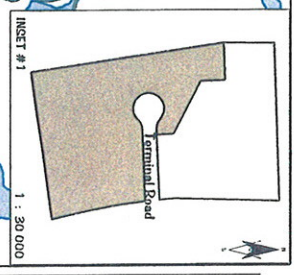
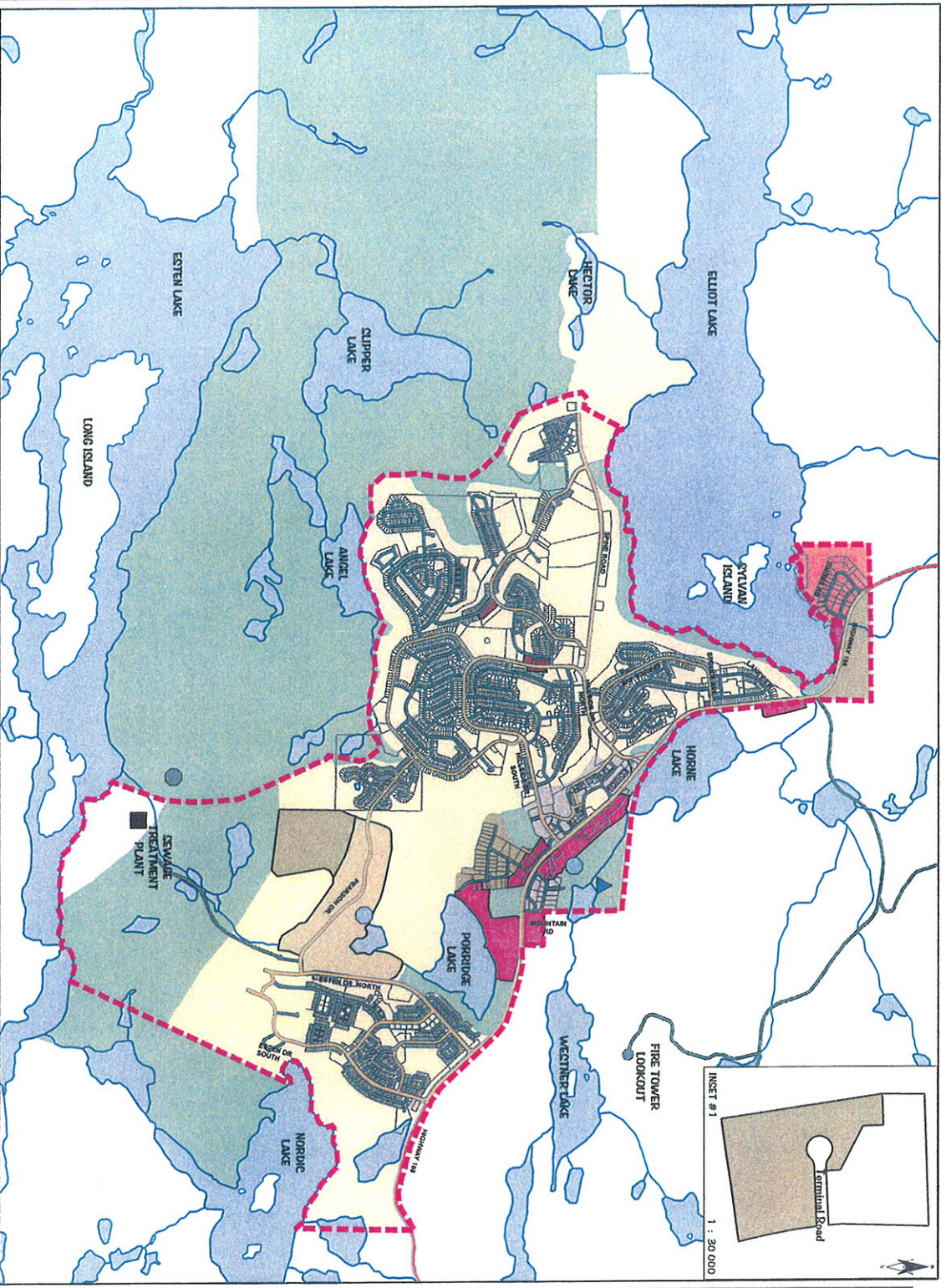

BASE MAP SOURCE:
CITY OF ELLIOT LAKE OFFICIAL PLAN - LAND USE SCHEDULE, W. 1998
PAUL H FORBANCE SURVEYING LTD. - CITY OF ELLIOT LAKE DIGITAL DATA









City of Elliot Lake

Official Plan

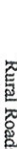
Land Use Schedule 'B'

Rural Area

Legend

-  Municipal Boundary
-  Provincial Highway
-  Rural Roads
-  Other Roads
-  Rural Areas
-  Urban Area (See Schedule 'A')
-  Tailings Management Areas
-  Waste Management Facility (Open)
-  Waste Management Facility (Closed)



Scale
1:135 000

